

**REGISTER SEARCH STATEMENT (Title Search) Transfer of
Land Act 1958**

VOLUME 10726 FOLIO 773

Security no : 124071983647J
Produced 24/05/2018 01:51 pm

LAND DESCRIPTION

Lot 818 on Plan of Subdivision 444490C.
PARENT TITLE Volume 10631 Folio 827
Created by instrument PS444490C 28/05/2003

REGISTERED PROPRIETOR

Estate Fee Simple
Sole Proprietor
LINA BARIDES of 2/65 TARCOOLA AVENUE MEADOW HEIGHTS VIC 3048
AR025799N 16/05/2018

ENCUMBRANCES, CAVEATS AND NOTICES

Any encumbrances created by Section 98 Transfer of Land Act 1958 or Section 24 Subdivision Act 1988 and any other encumbrances shown or entered on the plan set out under DIAGRAM LOCATION below.

DIAGRAM LOCATION

SEE PS444490C FOR FURTHER DETAILS AND BOUNDARIES

ACTIVITY IN THE LAST 125 DAYS

NUMBER		STATUS	DATE
AQ817520H (E)	NOMINATION TO PAPER INST.	Completed	13/03/2018
AR025798Q	DISCHARGE OF MORTGAGE	Registered	16/05/2018
AR025799N	TRANSFER	Registered	16/05/2018

-----END OF REGISTER SEARCH STATEMENT-----

Additional information: (not part of the Register Search Statement)

Street Address: 17 FRASERBURGH CRESCENT GREENVALE VIC 3059

DOCUMENT END

ADVERTISED PLAN
Page ..2... of ...11...
Date: 17/10/18 *incl. site*

This copied document is made available for the sole purpose of enabling its consideration and review as part of a planning process under the *Planning and Environment Act 1987*. The copy must not be used for any other purpose.

**REGISTER SEARCH STATEMENT (Title Search) Transfer of
Land Act 1958**

Page 1 of 1

VOLUME 10726 FOLIO 773

Security no : 124071983647J
Produced 24/05/2018 01:51 pm

LAND DESCRIPTION

Lot 818 on Plan of Subdivision 444490C.
PARENT TITLE Volume 10631 Folio 827
Created by instrument PS444490C 28/05/2003

REGISTERED PROPRIETOR

Estate Fee Simple
Sole Proprietor
LINA BARIDES of 2/65 TARCOOLA AVENUE MEADOW HEIGHTS VIC 3048
AR025799N 16/05/2018

ENCUMBRANCES, CAVEATS AND NOTICES

Any encumbrances created by Section 98 Transfer of Land Act 1958 or Section 24 Subdivision Act 1988 and any other encumbrances shown or entered on the plan set out under DIAGRAM LOCATION below.

DIAGRAM LOCATION

SEE PS444490C FOR FURTHER DETAILS AND BOUNDARIES

ACTIVITY IN THE LAST 125 DAYS

NUMBER		STATUS	DATE
AQ817520H (E)	NOMINATION TO PAPER INST.	Completed	13/03/2018
AR025798Q	DISCHARGE OF MORTGAGE	Registered	16/05/2018
AR025799N	TRANSFER	Registered	16/05/2018

-----END OF REGISTER SEARCH STATEMENT-----

Additional information: (not part of the Register Search Statement)

Street Address: 17 FRASERBURGH CRESCENT GREENVALE VIC 3059

DOCUMENT END

This copied document is made available for the sole purpose of enabling its consideration and review as part of a planning process under the *Planning and Environment Act 1987*. The copy must not be used for any other purpose.

Imaged Document Cover Sheet

The document following this cover sheet is an imaged document supplied by LANDATA®, Land Use Victoria.

Document Type	Plan
Document Identification	PS444490C
Number of Pages (excluding this cover sheet)	3
Document Assembled	24/05/2018 13:55

Copyright and disclaimer notice:

© State of Victoria. This publication is copyright. No part may be reproduced by any process except in accordance with the provisions of the Copyright Act and for the purposes of Section 32 of the Sale of Land Act 1962 or pursuant to a written agreement. The information is only valid at the time and in the form obtained from the LANDATA® System. The State of Victoria accepts no responsibility for any subsequent release, publication or reproduction of the information.

The document is invalid if this cover sheet is removed or altered.

This copied document is made available for the sole purpose of enabling its consideration and review as part of a planning process under the *Planning and Environment Act 1987*. The copy must not be used for any other purpose.

STAGE No. --- PLAN NUMBER PS 444490C
 PLAN OF SUBDIVISION

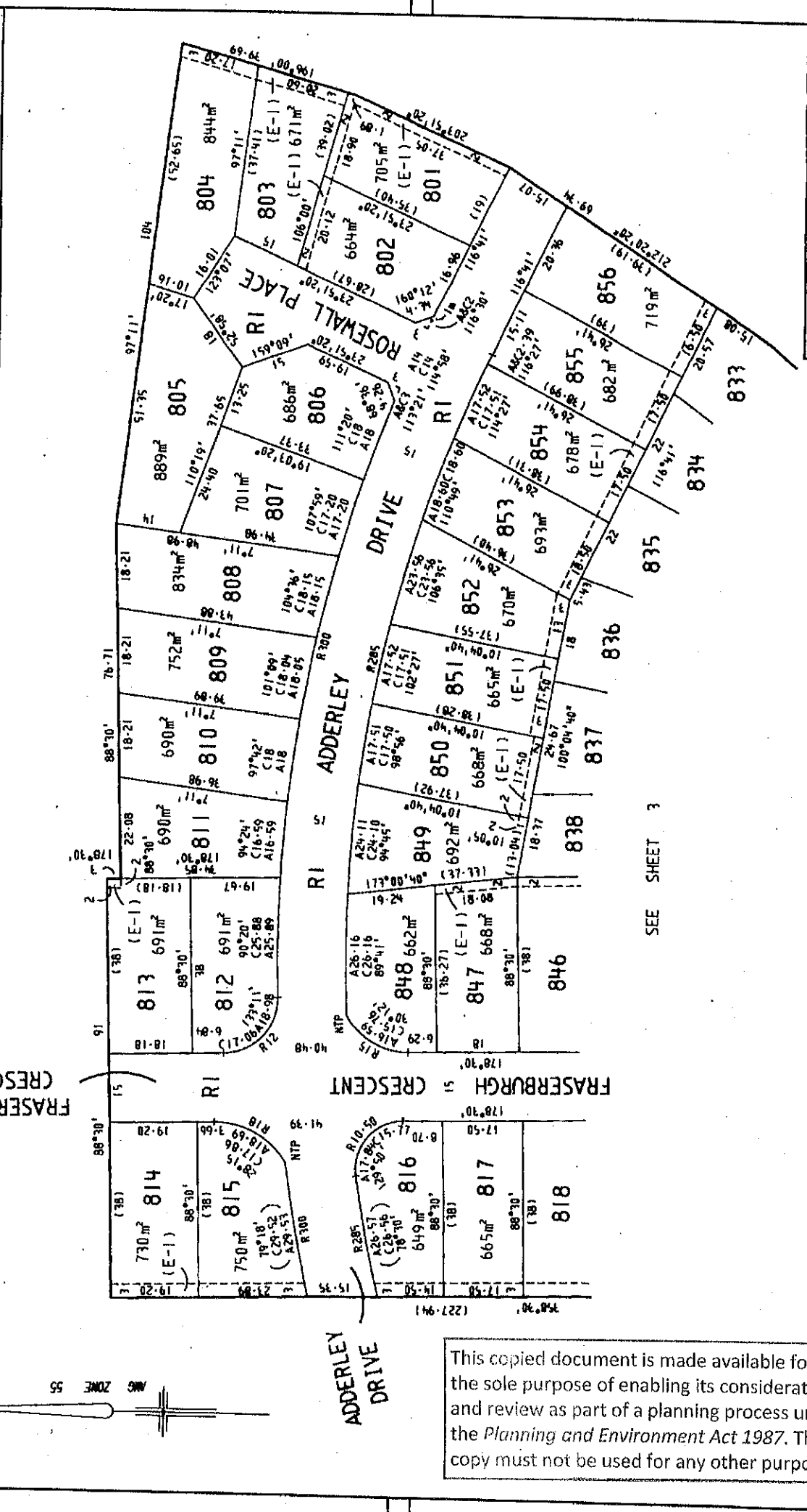

SEE SHEET 3

ORIGINAL SCALE 1:800 SHEET SIZE A3 LENGTHS ARE IN METRES 0 10 20 30 40 50 60 70 80 90 100 110 120 130 140 150mm	LICENSED SURVEYOR GEOFF W. HUMPHREY SIGNATURE REF: 1036/8 DATE 22/1/03 VERSION 3	SHEET 2 OF 3 SHEETS DATE / / COUNCIL DELEGATE SIGNATURE
---	--	---

This copied document is made available for the sole purpose of enabling its consideration and review as part of a planning process under the Planning and Environment Act 1987. The copy must not be used for any other purpose.

Dresser p/lit dixon pty ltd
 1 alfred street, hawthorn, vic 3122
 ph: 9818 0301 fax: 9819 5597

