

CLASS B CONCRETE FILLED  
 CIRCULAR CAST IRON INSERT WITH  
 2 STANDARD LIFTING KEY LUGS

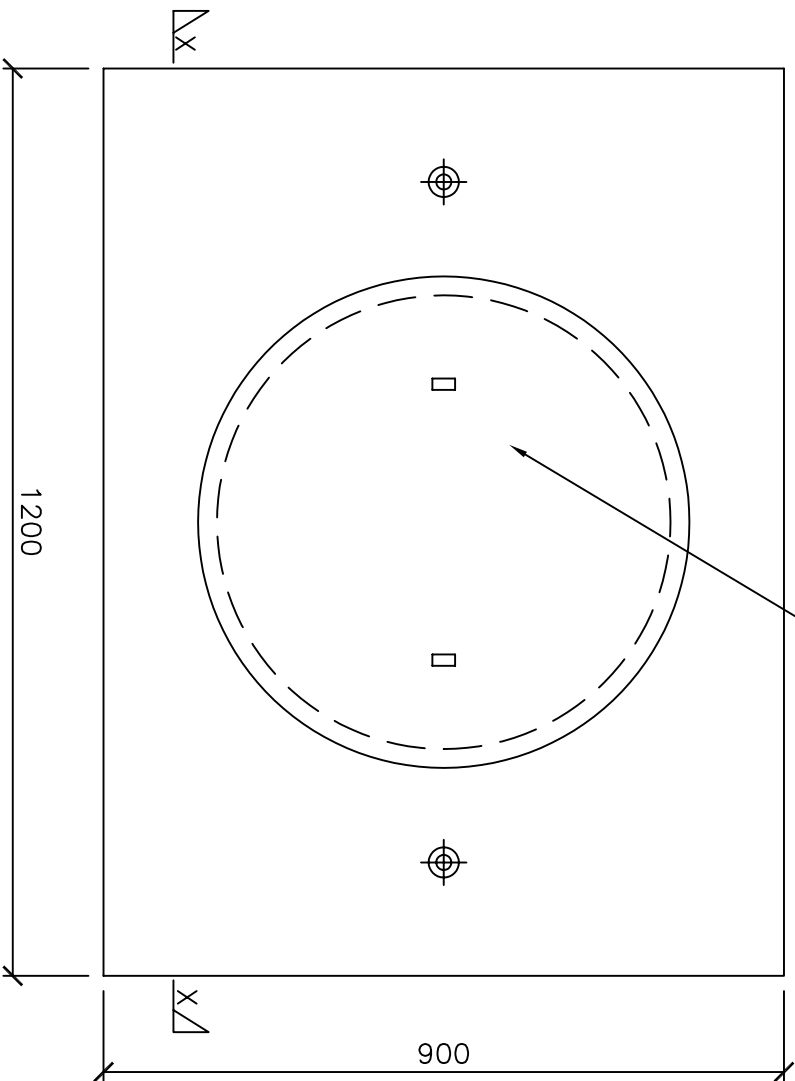

PLAN

2 NO. 1.3 TONNE X 55 LONG  
 SWIFT LIFTS FOR HANDLING

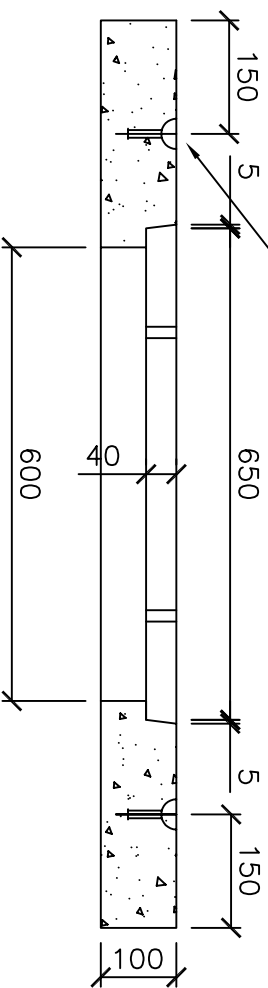

SECTION X-X

- NOTES: 1. THIS PIT LID TO BE USED ON ALL PITS WITH INTERNAL DIMENSIONS 900 x 600 AND LARGER.  
 2. CONCRETE STRENGTH 25MPa AT 28 DAYS

ALL DIMENSIONS ARE IN MILLIMETRES.

Amendments			
No.	Detail	Initials	Date
	DRAWN :	S. ADAMS	
	CHECKED :	R. DEVAPURA	
	APPROVED :	S. PLATER	
	SCALE :	1 : 15	
	DATE:	JUNE 2004	



P.O. Box 119  
 Broadmeadows  
 Victoria 3047  
 Telephone 03) 9205 2200  
 Facsimile 03) 9309 0109

PRECAST CONCRETE PIT LID  
 WITH CAST IRON INSERT

DRAWING NO:

SD275