

PLAN

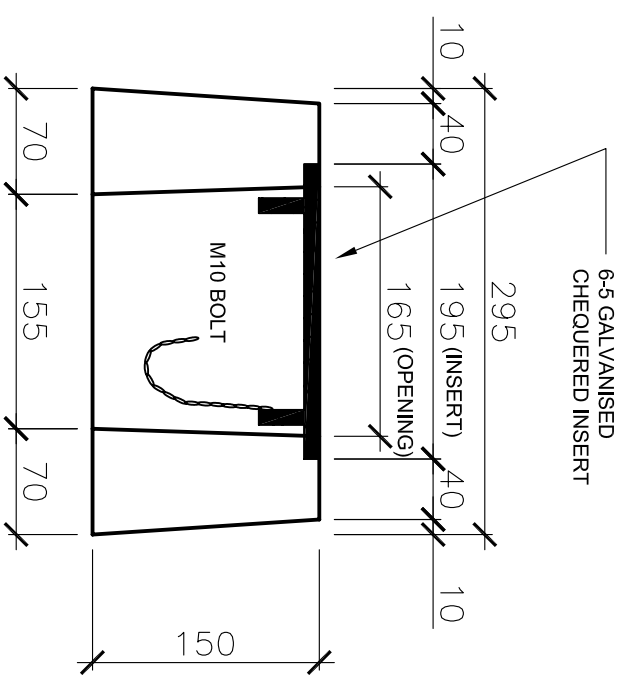

SECTION

- NOTES:
 1. SURVEY MARKER TO BE INSTALLED WITHIN FOOTPATH AREAS WHERE POSSIBLE.

Initials	Date	DRAWN :	S. ADAMS
R.C.	Jan 05	CHECKED :	S. PLATER
		APPROVED :	S. PLATER
		SCALE :	1 : 50
		ISSUE DATE:	JUNE 2004

HUME
CITY COUNCIL

P.O. Box 119
 1079 Pascoe Vale Road
 Broadmeadows
 Victoria 3047

Telephone
 (03) 9205 2200

Facsimile
 (03) 9309 0109

TYPE :	SURVEY MARK COVER
DRAWING NO.:	SD 409