

TYPICAL CROSS SECTION

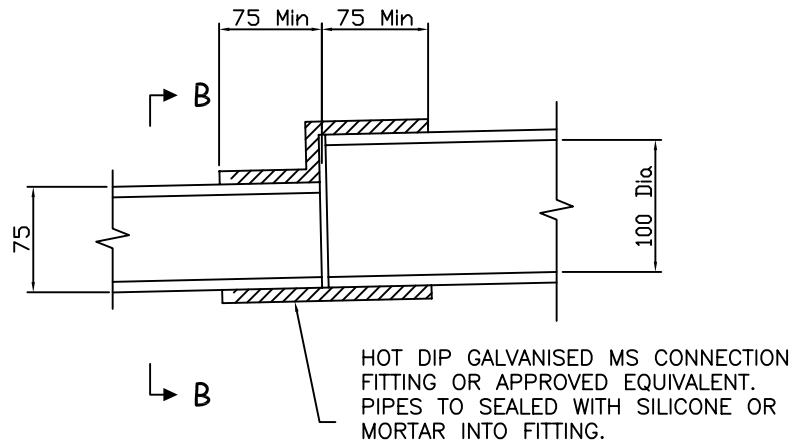

DETAIL 'A'

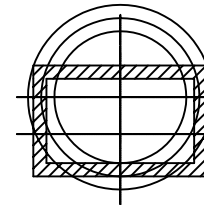

SECTION B-B

FITTING FOR CONNECTION OF 100mm DIA. UPVC PIPE TO 125 X 75 X 6mm MS SECTION

NOTES:

1. THIS IS ONLY TO BE USED IN SPECIAL CASES. GENERALLY THIS IS ONLY USED FOR MAINTENANCE OR RECONSTRUCTION WORKS. APPROVAL FOR USE IS REQUIRED FROM TEAM LEADER CIVIL DESIGN.
2. UPVC PIPE TO BE 100mm HEAVY DUTY DWV CLASS SN6
3. ALL STEEL WORKS TO BE HOT DIP GALVANISED
4. ALL JOINTS ON PVC PIPE TO BE SEALED WITH SOLVENT WELD CEMENT (TYPE N OR P), OR RUBBER RING JOINT.

ALL DIMENSIONS IN MILLIMETRES

Amendments			
No.	Detail	Initials	Date
1.	UPVC PIPE CLASS CHANGED TO NEW CODE	R.C.	Jan 05

DRAWN : R. CHARTERS
 CHECKED : R. DEVAPURA
 APPROVED : S. PLATER
 SCALE : N.T.S
 ISSUE DATE: JUNE 2004



PO Box 119
 1079 Pascoe Vale Road
 Broadmeadows
 Victoria 3047

Telephone
 (03) 9250 2200

Facsimile
 (03) 9309 0109

TYPE : PROPERTY CONNECTION TO KERB
 IN EXISTING RESIDENTIAL AREAS

DRAWING NO: SD285