

TIE BARS (USE R16 M.S BARS, 450mm LONG)
AT MAXIMUM 300mm CENTRES TO BE
DRILLED & INSTALLED AT EXISTING E.J OR C.J.

REINSTATEMENT TO BE CARRIED
OUT TO NEAREST EXISTING JOINT
IN THE FOOTPATH. ie. FULL BAYS
NEED TO BE REINSTATED.

SL62 MESH
CENTRALLY
LOCATED

EXISTING FOOTPATH

EXISTING EXPANSION
JOINT (E.J) OR
CONTRACTION JOINT
(C.J)

125mm MIN THICK CONCRETE

DEPTH REFER TO
SERVICE AUTHORITY
REQUIREMENT - MIN. 450mm

20mm CLASS 3 CRUSHED ROCK
COMPACTED TO 98% STANDARD
COMPACTION, IN 150mm LAYERS.

SERVICE MAIN, CONDUIT
SIZE VARIES.

BEDDING & BACKFILLING AROUND
THE PIPE REFER TO SERVICE
AUTHORITY REQUIREMENT.

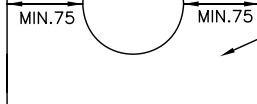

MIN. 75 MIN. 75

MIN. 300

NOTES:

1. WEAKENED PLANE JOINTS SHALL BE LOCATED AT 1.5m CENTRES AND MAY BE MADE WITH A 'T' IRON (OR CONCRETE SAW WITHIN 24Hrs OF POUR)
2. CONCRETE SHALL BE 25 MPa AT 28 DAYS. (32MPa FOR COLOUR CONCRETE)
3. FORMWORK TIMBER TO BE MIN 125mm DEEP
4. EXPANSION JOINTS AT MAXIMUM 18m CENTRES
5. THE FINISHED SURFACE LEVEL OF THE REINSTATEMENT TO BE FLUSH WITH EXISTING FOOTPATH.
6. THE AUTHORITY/CONTRACTOR SHALL BEAR THE COST OF REINSTATEMENT OF THE ROAD RESERVE AND/OR ROAD PAVEMENT AND BE RESPONSIBLE FOR THE COST OF REPAIRS AND MAKING GOOD ANY DAMAGE TO EXISTING SERVICES AND OTHER ASSETS.
7. ALL DIMENSIONS ARE IN MILLIMETERS

REINSTATEMENT OF CONCRETE FOOTPATH

Amendments			
No.	Detail	Initials	Date
A	Backfill Changed To Class 3	R.C.	14 March 07

DRAWN : C. NGUYEN
CHECKED : R. DEVAPURA
APPROVED : R. DEVAPURA
SCALE : NOT TO SCALE
ISSUE DATE: OCTOBER 2005



PO Box 119
1079 Pascoe Vale Road
Broadmeadows
Victoria 3047

Telephone
03) 9205 2200

Facsimile
03) 9309 0109

REINSTATEMENT OF CONCRETE FOOTPATH
SERVICE AUTHORITY RENEWALS/INSTALLATION
DRAWING NO: SD417